



# Owner's Manual

Sage Series

All Weather Wall Mount Installation

## Table of Contents

Introduction | 3

What's Included | 3

Getting Started (Important!) | 4

Tools you may need | 5

Installing the Wall-mount Bracket | 6

Installing Speaker Cover | 16

Care and Maintenance | 16

North American Warranty | 17

Obtaining Service | 18

Dimensions | 19

### DOCUMENT CONVENTIONS

This document contains general safety, installation, and operation instructions for the Wisdom Audio Sage Series Minimum Appearance Solid Surface Kit. It is important to read this document before attempting to use this product. Pay particular attention to:

**WARNING:** Calls attention to a procedure, practice, condition or the like that, if not correctly performed or adhered to, could result in injury or death.

**CAUTION:** Calls attention to a procedure, practice, condition or the like that, if not correctly performed or adhered to, could result in damage to or destruction of part of or the entire product.

**Note:** Calls attention to information that aids in the installation or operation of the product.

## Introduction

This installation guide covers both the 52" and 76" tall Sage Series speakers. The mounts are intended to simplify the installation of the Sage outdoor speakers where irregular wall surfaces are common. The Sage Series On-Wall mounts use a multi-piece design that allows a single person to handle all or nearly all parts of the installation without assistance. The design is intended to be universal for most surfaces. However, it may not be suitable for some surfaces or installations. It is left to the installer to determine the feasibility of the Sage Series On-wall mount.

Mounting hardware is provided but may not work for every installation. It is left to the installer to determine if the hardware is suitable or if additional or alternative hardware is required.

The following installation guide does not cover the installation of the speaker cable. However, this manual does contain information that should be used to determine the optimal location for the cables to exit the wall.

## What's Included

1. Full-size Speaker Cardboard Template with 6 Double-stick Adhesive Pads
2. Speaker Supports (*Dependent on model, Qty = 1, 2, or 3*)
3. Support Bridge (only for 76" Multiple-support Models, such as L150)
4. Installation Hardware for Wood and Masonry
5. Neoprene Gasket and Plug Set
6. Abutment (Single, Double, or Triple)

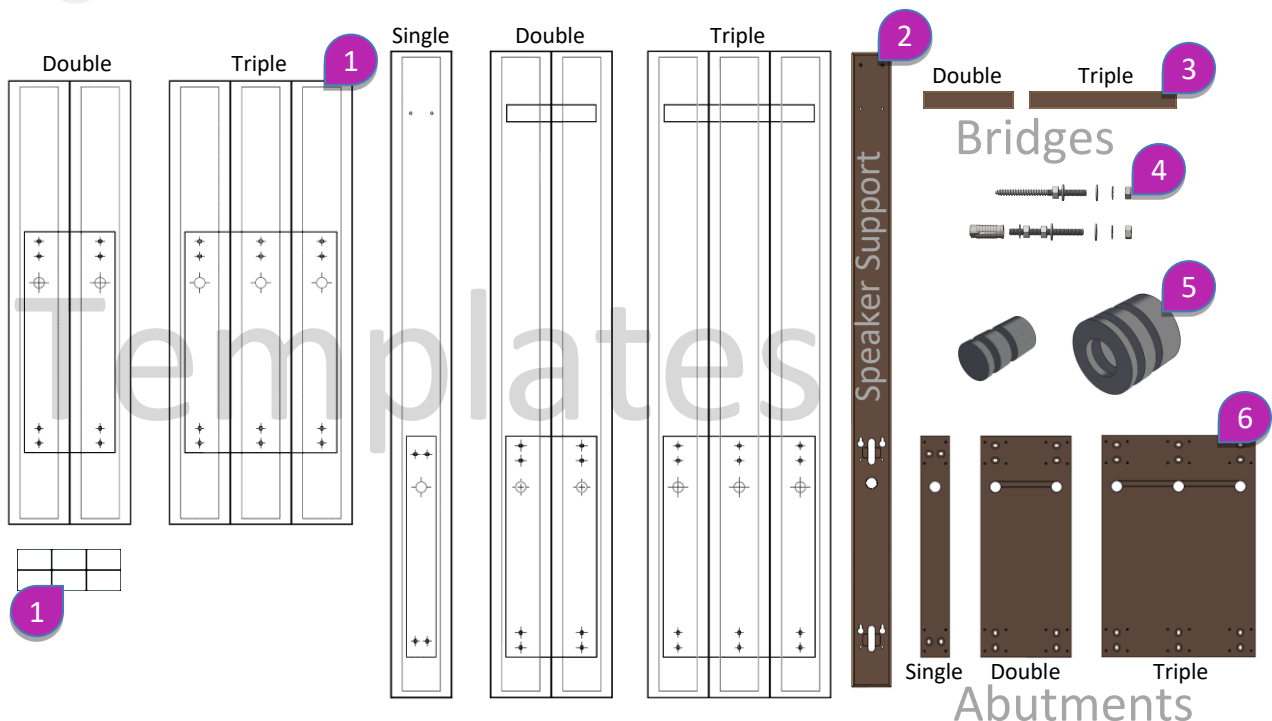

## Getting Started (Important!)

First, familiarize yourself with the installation instructions, the component parts of the wall mount, and any accommodation you may need for your installation.

Establish the location for each speaker. The cable exit location can be determined by using the dimensions provided in this section and the **Dimensions** section at the end of the manual. A cardboard template is also provided that has the cable location cut out.

Ideally, the wire should exit the wall immediately behind the speaker cable holes of the mounting brackets. One or more holes can be used for all the cables depending on one's needs. For the Triple Mounts, it may be necessary to use two holes unless 4 conductor cable is used.

The Mounting Height should be made according to the requirements of the listening space and the height of the listeners' ears when standing, sitting, or even lying down. Use the chart below for determining the approximate mounting height of your speaker model. As an example: A typical mounting height for the L100m is 28" (71cm) from the floor. This is suitable for people up to 6'8" (203cm) tall. The minimum ear level for this mounting height would be 32" above the floor.

For the 76" models, such as an L150, a typical mounting height is 8" (20cm) from the floor. This is suitable for people up to 7'2" (218cm) tall. The minimum ear level for this mounting height would be 12" (30cm) above the floor. Adjust the height as necessary for your installation.

**NOTE:** It is necessary to have a minimum of 3/4" (19mm) of clearance above the speaker to allow the speaker to be lifted onto the speaker mounting cleats.

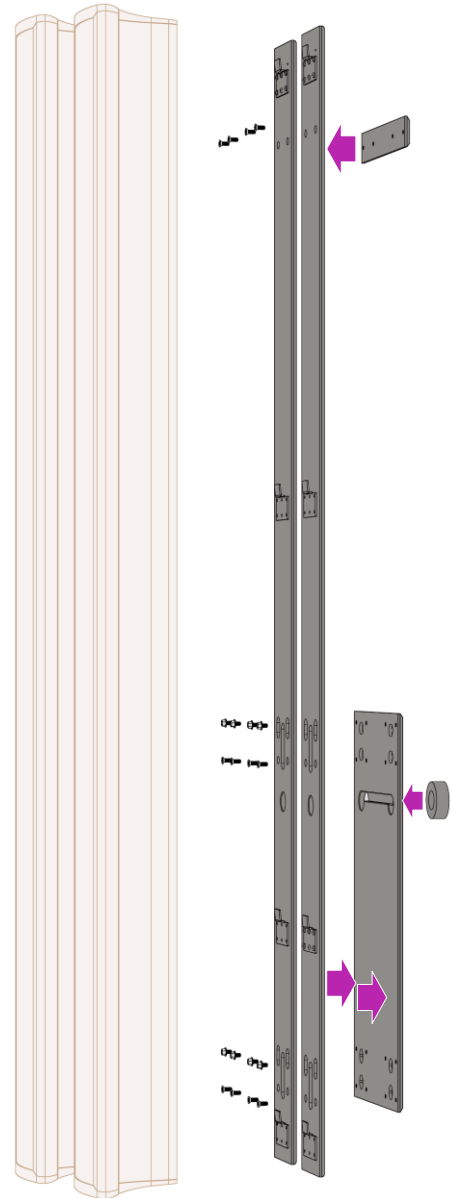

| Speaker Model | Suggested Mounting Height<br>(From ground to <u>bottom</u> of speaker) | Suggested Mounting Height<br>(From ground to <u>top</u> of speaker) |
|---------------|--|---|
| L100AWm (52") | 28" (71cm)   | 80" (203cm)   |
| C150AWm (52") | 28" (71cm)   | 80" (203cm)   |
| L75AWm (76")  | 8" (20cm)  | 84" (213cm)   |
| L150AWm (76") | 8" (20cm)  | 84" (213cm)   |
| C225AWm (76") | 8" (20cm)  | 84" (213cm)   |

Use the diagram below along with the above chart to determine the optimal height of the speaker. Account for any elevation changes in the outdoor environment by adjusting the height and angle of the wall mounts. Additional dimensions can be found at the end of the manual in the **Dimensions** section.

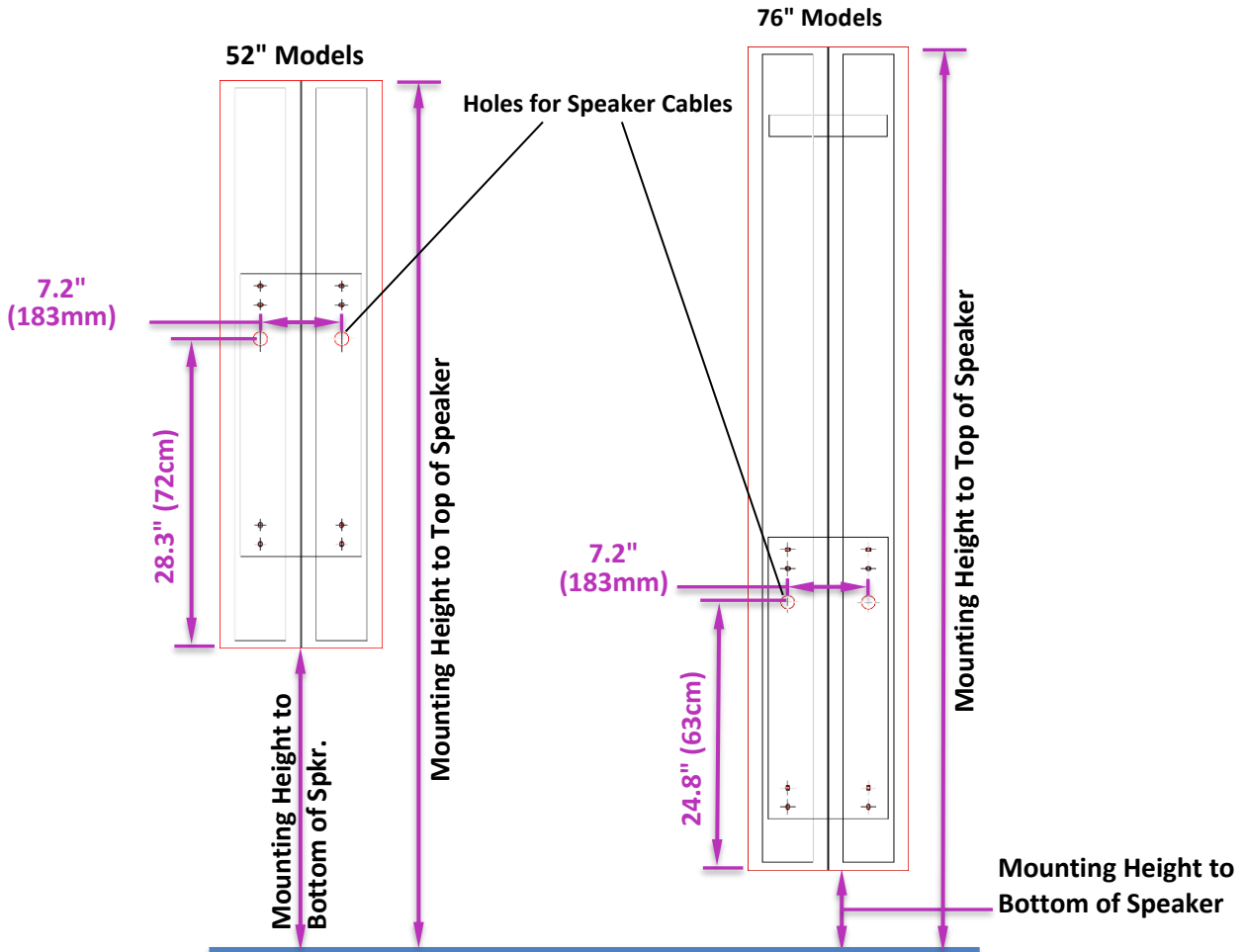

**NOTE:** The templates are full-size. They are the same height and width as the speakers, (Red outline). Drawn on the templates are the location of the abutment and the support bridge. Abutment mounting holes and wiring holes are precut in the templates.

### Tools you may need

1. Drill & Drill bits for your installation.
  - 3/16" for wood
  - 1/4", 1/2", and 3/4" for masonry
2. Wrenches: 7/16" open-end (X2)
3. 3/8" & 7/16" Sockets and Wrench
4. Bubble Level: 24" Minimum Length
5. Philips Screwdriver: #3
6. Mallet or Hammer
7. Wire Cutter / Stripper
8. 3/32" Hex Key (wrench)

## Installing the Wall-mount Bracket

The following installation steps assume that the speaker locations have been determined, the speaker cables have been run, and the cables are hanging out of the wall in the location of the speaker cable pass-throughs.

### 1. Attach Template to Wall Surface

- a. Place up to 6 of the double-stick pads onto the back of the template or onto the wall in feasible locations where the template can be properly supported. It is recommended that at least one of the pads be attached immediately adjacent to the hole where the speaker cable will pass through the template. This provides an anchor point around which the template can pivot while maintaining close alignment with the speaker cable exiting the wall.

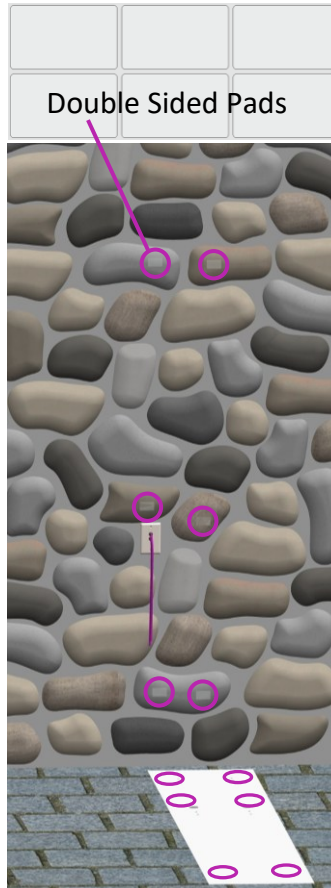

Align the template using a bubble level or similar.

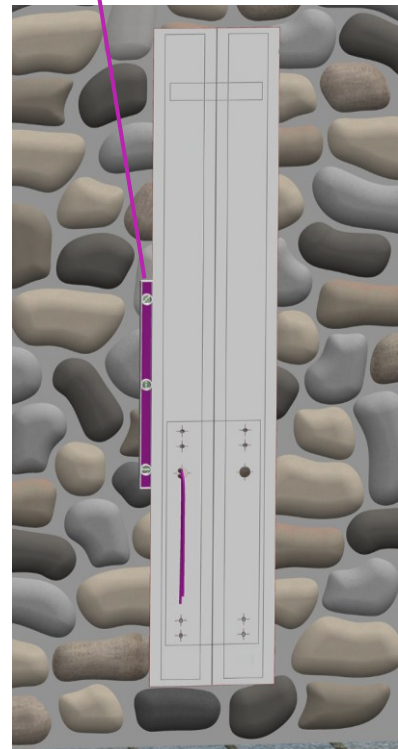

- b. Alternatively, should the wall surface be highly irregular, it may be prudent to attach the double-stick pads to the high points of the wall surface.  
NOTE: The double-stick pads have excellent adhesion which increases with time. The pads stick very well to irregular surfaces. Use care and go slowly when removing the pads from the wall surface to prevent damage to the surface. Stretching the pads may aid in their removal.
- c. Attach the template to the wall, **aligning it vertically using a bubble level.**

2. Drill Holes for Attachment Hardware

- a. Carefully drill out the holes for the attachment hardware you will use.

**NOTE: It is important that the holes are drilled on-center and perpendicular to the wall surface. Failure to do so can make it difficult or impossible to mount the Abutment.**

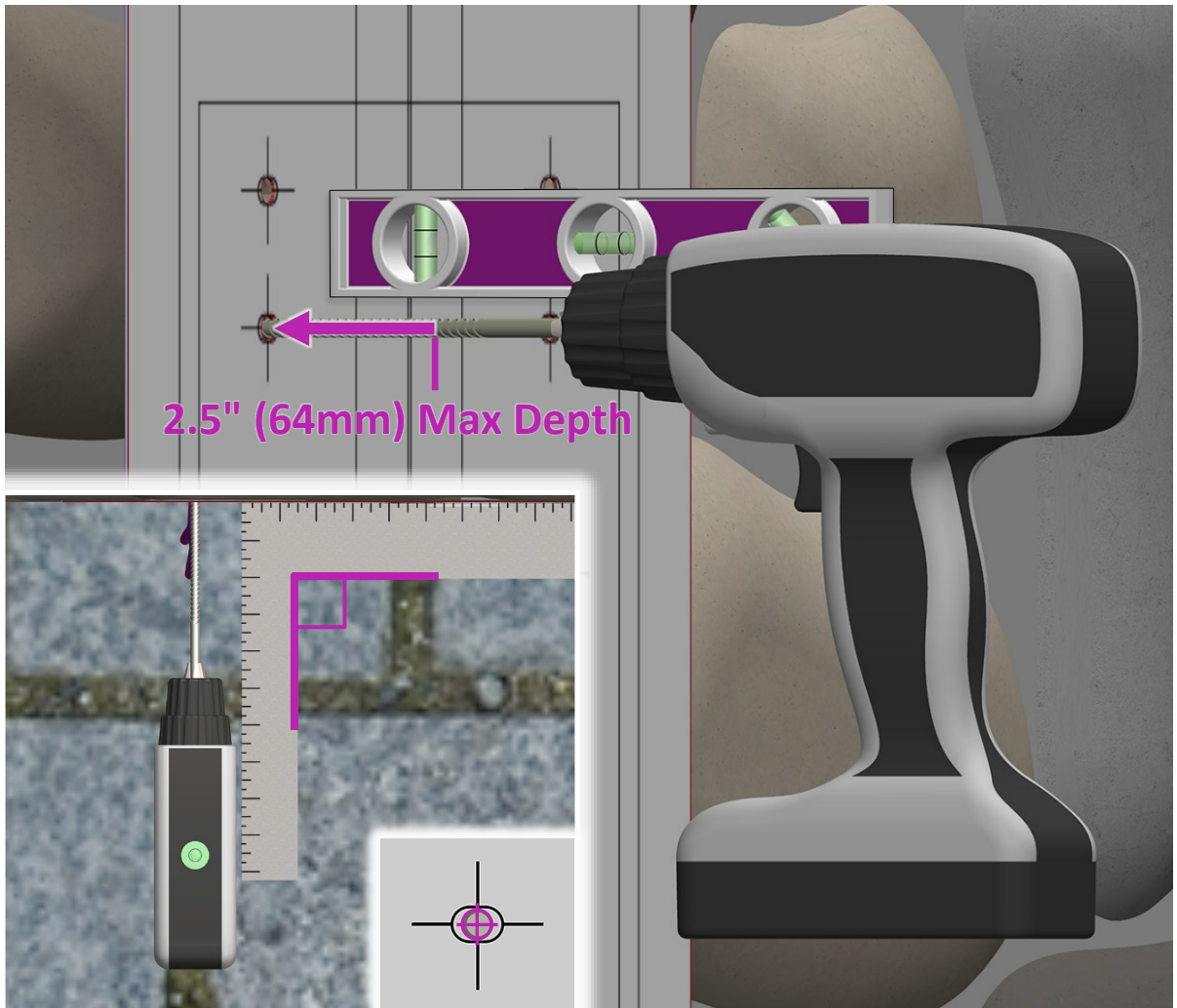

- b. For masonry, it is recommended that a smaller drill bit, such as a 1/4" diameter drill bit be used prior to drilling the final 1/2" diameter holes.
- c. In masonry, the holes can be drilled up to 2.5" (64mm) deep. This depth ensures the threaded rod has enough clearance for all installations. The minimum depth required for the anchor is 1.3" (33mm).

- d. After ensuring the holes are drilled in correct locations, Enlarge the holes to fit the anchors.

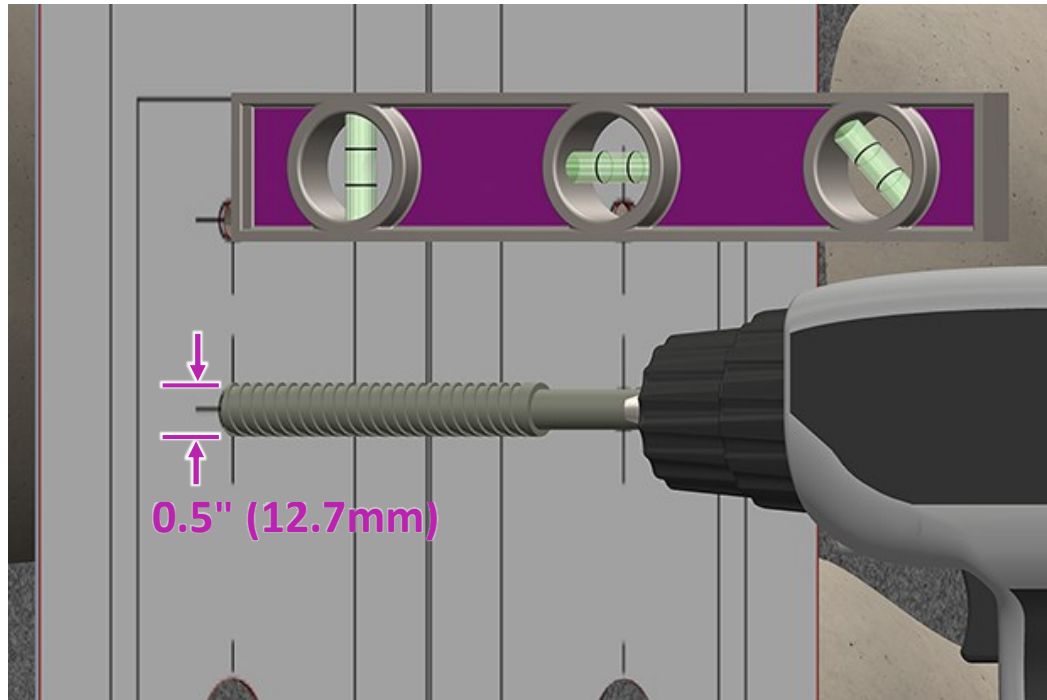

- e. If anchors are installed in an uneven surface, add a shallow clearance around the holes to allow space for the nuts and a wrench. This will ensure that a nut can be fully seated against the face of the anchor. The clearance can be made with an oversize drill bit or grinder. A 3/4" (19mm) drill bit would be the minimum recommended size for hardware clearance. Additional clearance may be needed for a wrench depending on the irregularity of the surface and the type of tool used.

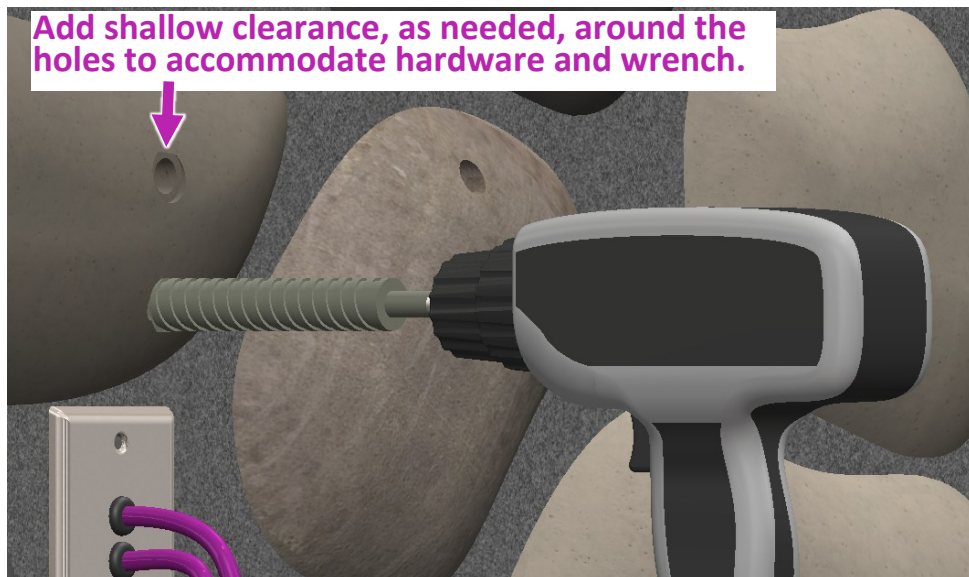

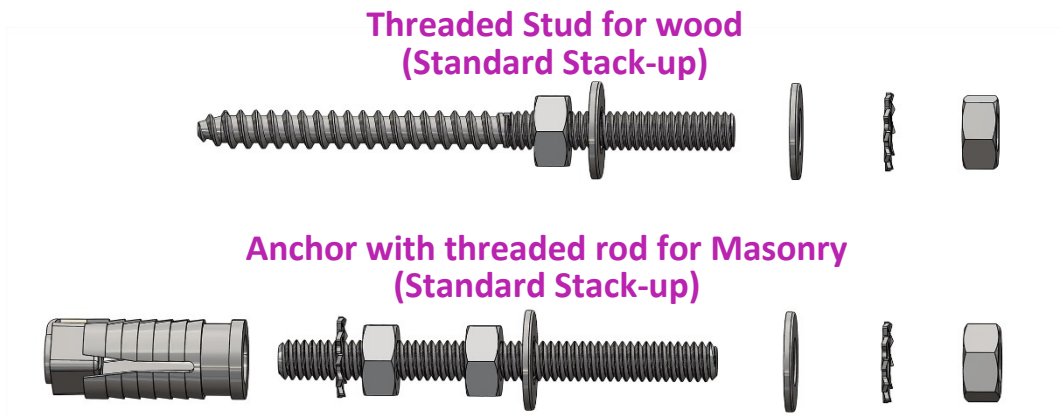

- f. For attachment into wood, 3.5" (89mm) long x 1/4" (6.3mm) diameter threaded studs are provided. Drilling a pilot hole with a 3/16" (4.5mm) drill bit is recommended for most wood materials.

3. Install Attachment Hardware

- a. **For Masonry:** Insert the threaded rods into the anchors and place a nut up against the face of the anchors. Place another nut at the very end of the anchors and slide or tap the anchors into the holes until even with the face. If the anchor is tight, the hole can be opened up slightly by running the drill bit into the hole again.

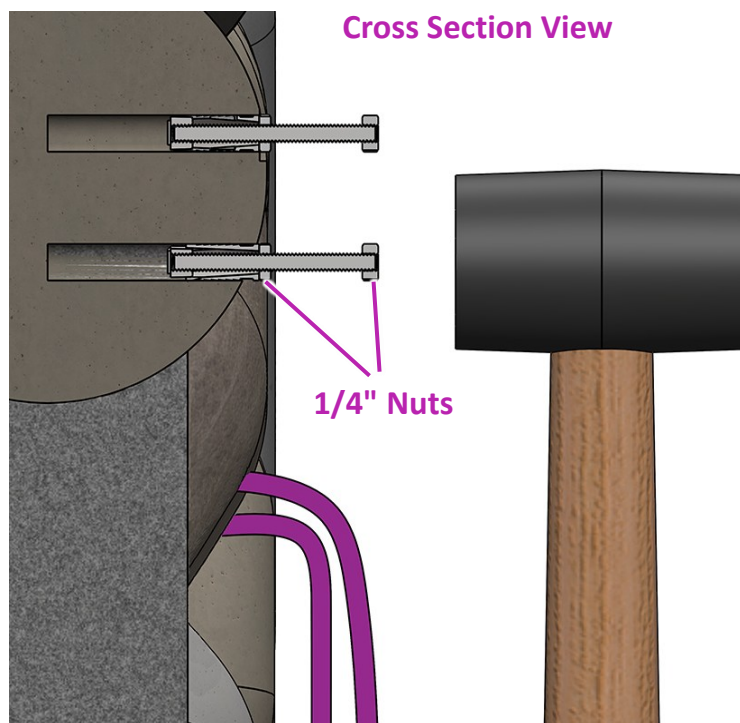

**NOTE: The nut at the end of the anchor protects the threads from damage. The nut placed against the anchor carries the load and drives the anchor without damaging it. It should not require a lot of force to drive the anchor. If it begins to bind, immediately remove the anchor and enlarge the hole. Additionally, do not begin tightening the anchor wedge before installing the anchor. The wedge must have a loose fit at the time of installation.**

- b. Using a level, thread the rods into the anchors so that they are all evenly aligned. The threaded rods should extend about 3/4" (19mm) past the highest point on the mounting surface. Tighten the binding nuts to secure the anchors.

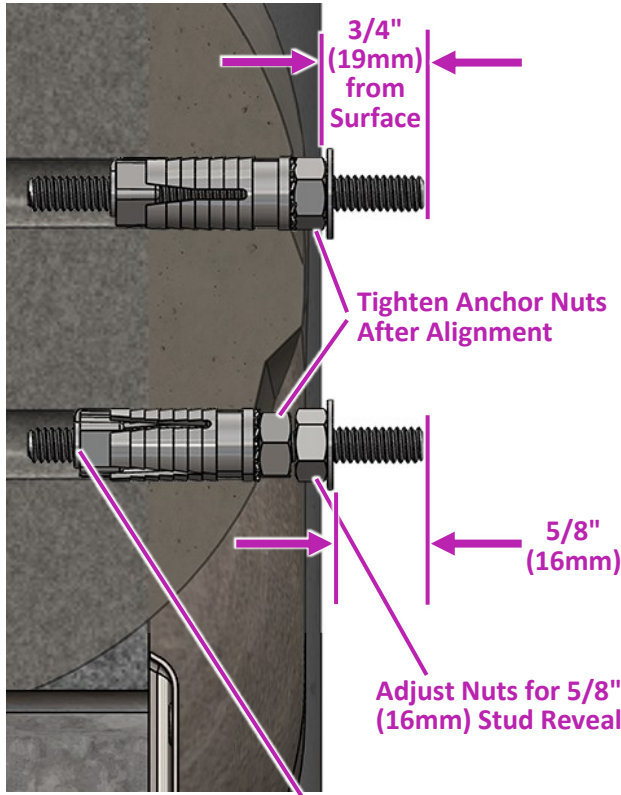

Note: As designed, the stop at the back of the anchor will yield when the threaded rod is inserted beyond 1.3" (33mm).

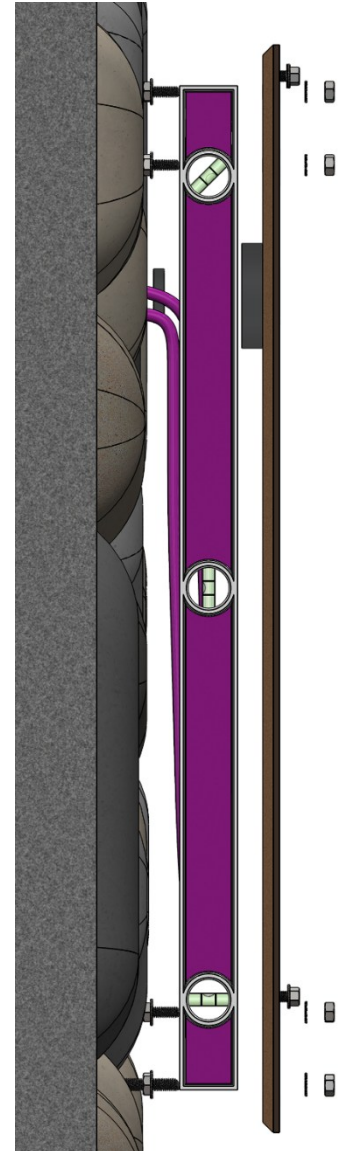

- c. Set the depth of the backing-nut and washer 5/8" (16mm) behind the front of the threaded stud. Fine positioning of the hardware should be performed with the abutment in place.

Installation of abutment is shown in the steps following the next step, (*Attachment to Wood*).

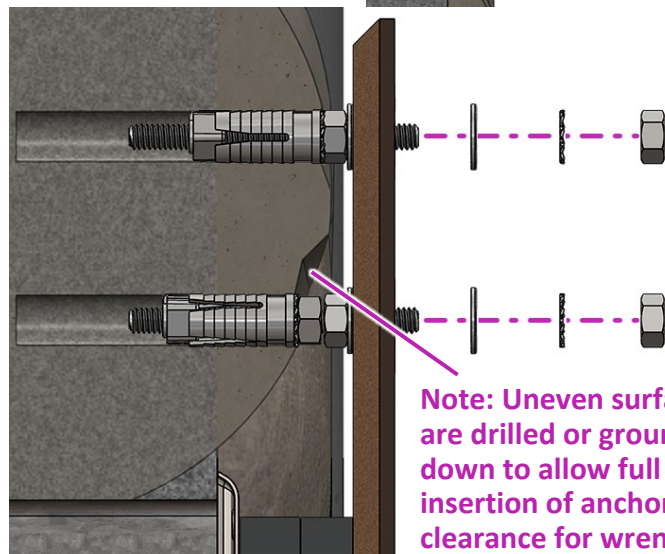

#### 4. Attachment to wood

- a. For installations where the abutment will be attached to wood, use the Threaded Stud or other suitable hardware.
- b. Pre-drill all holes using a 3/16" (4.7mm) drill bit.
- c. Place two nuts on the end of the stud and jam them together. Drive the outside nut with a wrench or socket.
- d. Set the depth per the instructions above. 5/8" (16mm) of thread should be exposed for attaching the abutment.

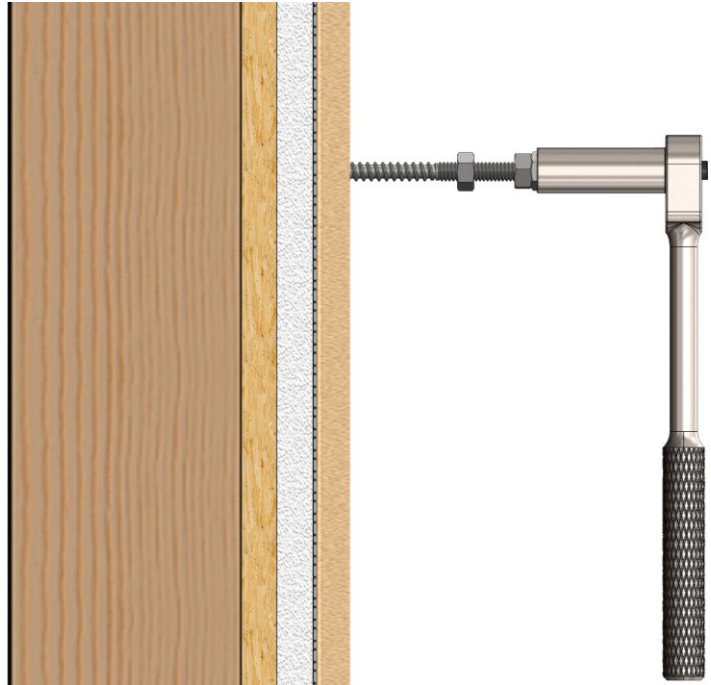

#### 5. Install Abutment

- a. Attach foam gaskets over the holes used for wiring. Choose the ring with the desired thickness. Peel the backing and stick them onto the backside of the abutment. Stack the rings if needed to gain the desired thickness. Any holes that are not used for wiring can be plugged using one of the foam plugs.
- b. Pulling the speaker cable through the hole(s), place the abutment onto the anchors or studs. Use a washer and lock washer, followed by a nut. Make any final adjustments to ensure the abutment is level and tighten all attachment hardware.

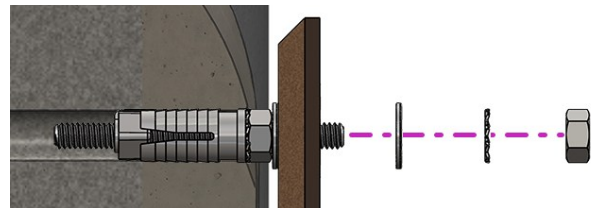
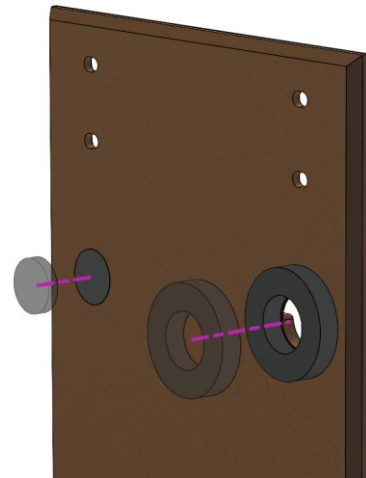

6. Install Speaker supports

- a. Install the long and short flathead screws at the top of the backside of the support brackets. Prior to inserting the screws, coat the screws and the inside of the holes with a layer of Tef-Gel<sup>®</sup> following the manufacturer's instructions.

The long screw is for locking the speaker into place after final assembly. It should be placed to the outside edge of the support bracket where it will be accessible when the speaker is installed. The short screw will seal the secondary hole. Tighten the short screw fully.

**Note: The long screw should only be partially installed so the thread begins to appear on the front side of the support bracket. It will be tightened after the speaker is installed on the bracket.**

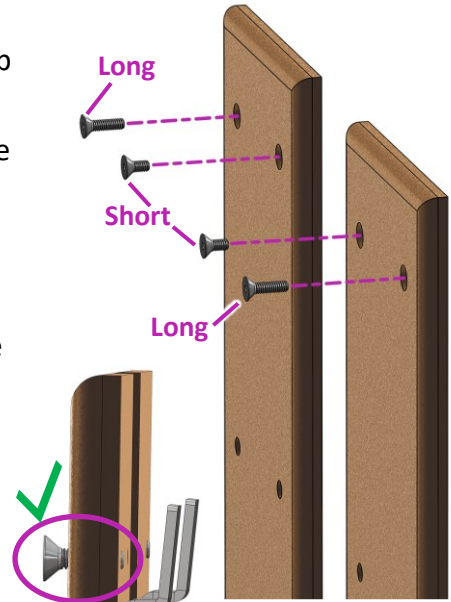

- b. Using two 1/4" flathead screws, attach the Support Bridge to one of the speaker supports.

**Note: Support Bridges are only used on double and triple wall mount brackets.**

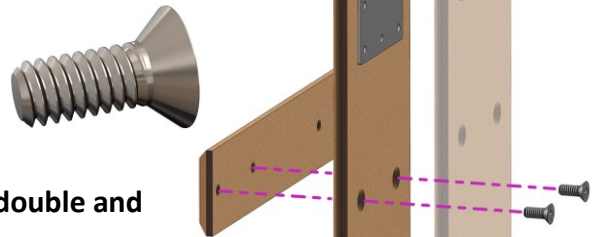

- c. For single mounts, (L75AWm), install Press-fit Binding Barrels in the top 1/4" holes of the speaker supports. The two parts can be pressed together using pliers if needed.

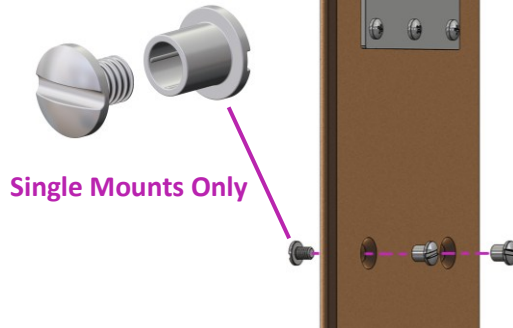

- d. Install the serrated bolts, (3 turns), into the abutment. There are 4, 8, or 12, depending on model. They are installed in the 1/4" holes above each abutment-attachment location, as illustrated. Prior to inserting the screws, coat the screws and the inside of the holes with a layer of Tef-Gel<sup>®</sup>, following the manufacturer's instructions. This will prevent seizing of the hardware and reduce the possibility of galvanic corrosion.

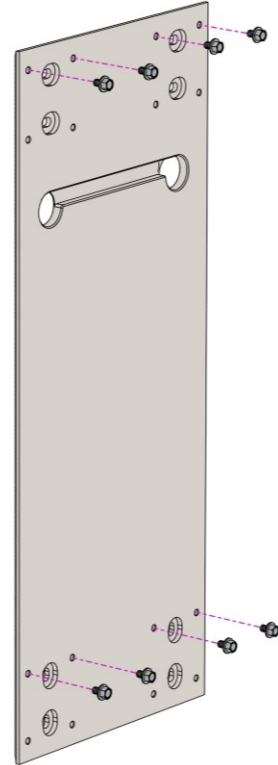
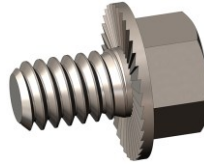

- e. Attach the Support Brackets to the Abutment by placing the keyhole slots onto the serrated bolts. Route the speaker cables as desired. Use the wire channel in the abutment to route cable between the support brackets.

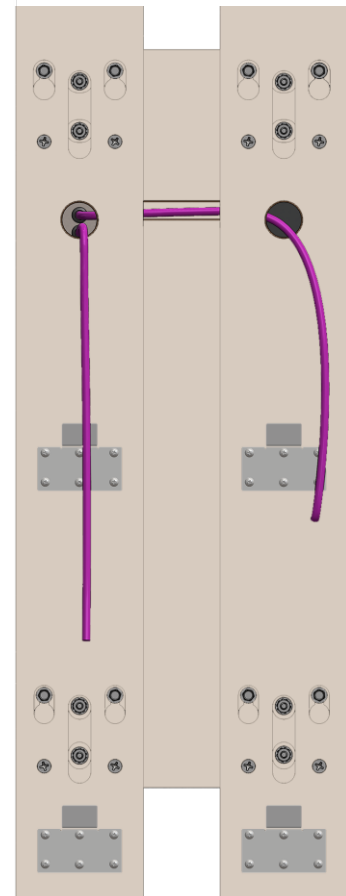
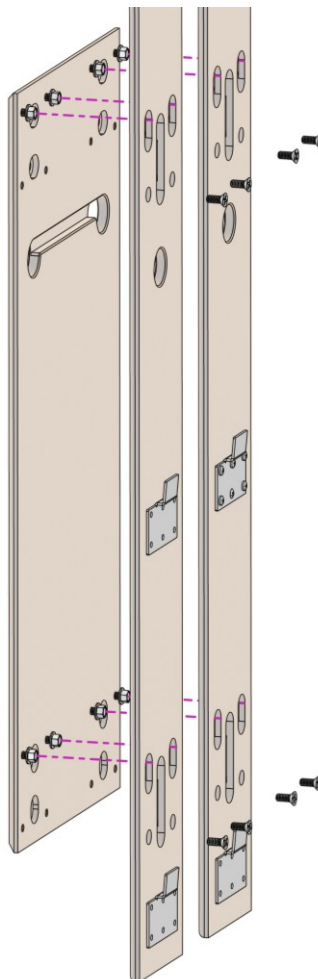

- f. Using 1/4" flathead screws, attach the Support Bridge to the other Speaker Supports. Again, coat the screws and the inside of the holes with a layer of Tef-Gel, following the manufacturer's instructions. This feature is only present on double and triple mounts.

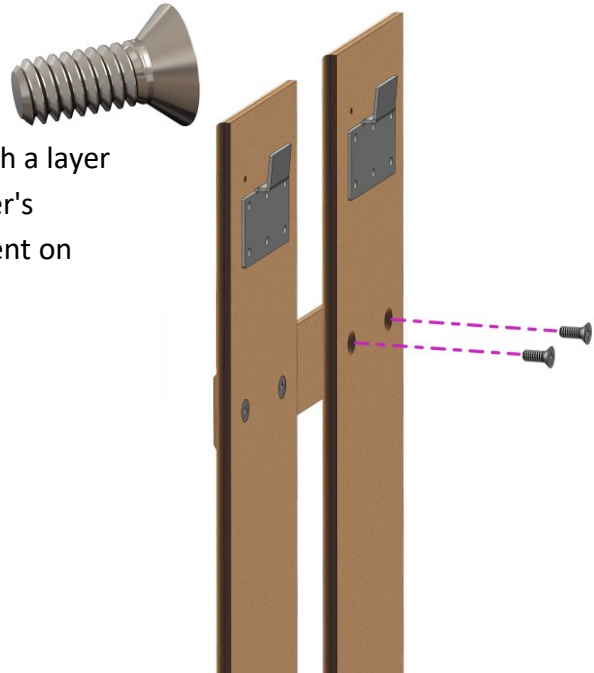

- g. Insert the 1/4" flathead screws, but do not tighten yet. Remember to coat the screws and the inside of the holes with a layer of Tef-Gel, following the manufacturer's instructions.

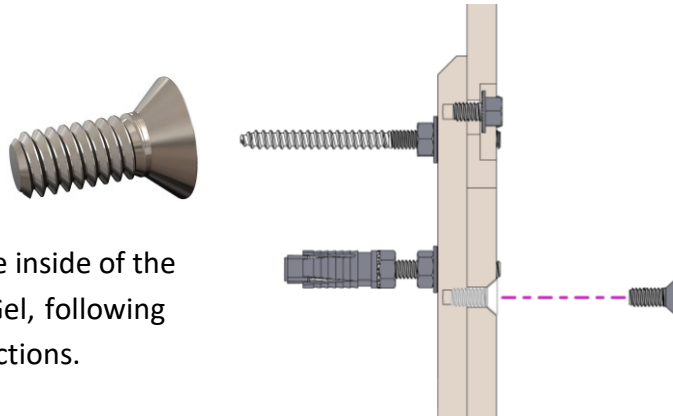

- h. Tighten all hardware beginning with the flat head screws, including the 1/4" screws in the Support Bridge. Follow this by tightening the serrated bolts.

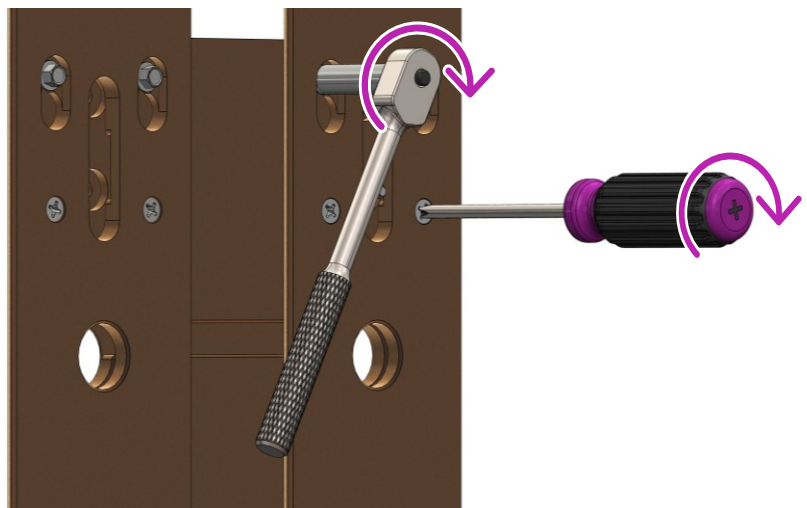

7. Connect speaker cables and hang speaker modules.

**Caution: Refer to the speaker's owner's manual for instructions on wiring your speakers.**

- a. Prepare the wires for connection. You will want to have 12" to 16" (30cm to 40cm) of cable available after routing through the wall-mount bracket.
- b. Prepare the ends of the wire by stripping approximately 5/8" (16mm) from the end of the cable.
- c. Place a soft piece of material, such as cardboard or foam packing material alongside the wall-mount bracket to protect the speaker.
- d. Place the speaker on the protective material and connect the speaker as recommended in the speaker's manual. Ensure proper polarity and channel assignment are performed correctly or severe damage could be done to the speaker.
- e. If your speaker uses multiple modules, we recommend hanging the woofer columns first since they are heavy and more difficult to handle.
- f. Note: The LF columns for the double mount shall be mounted to the inside of the HF columns. Please refer to the speaker's manual.

- g. Tighten the locking screws at the top of the support brackets using a 3/32" hex key (hex wrench). One long screw is provided for each speaker module.

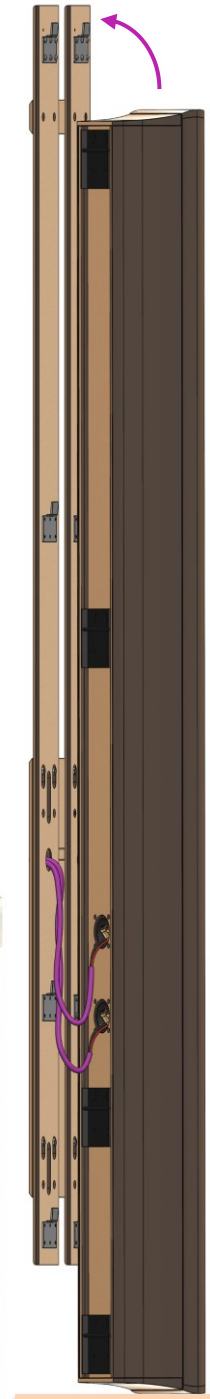

Set Speaker on Protective Material

## Installing Speaker Cover

To preserve the longevity of your speakers, we recommend covering them when unused for extended periods of time and during harsh weather conditions.

1. Lay out the cover and tighten (cinch) the cords at one end of the cover just enough to hang it over the top of the speaker.
2. Place the cinched end of the cover over the top of the speaker.
3. Wrap the other end over the bottom of the speaker and tighten all the cords.
4. Wrap the hook-and-loop strap around the middle of the speaker. Pull the cover tight around the back of the speaker and secure the strap firmly.

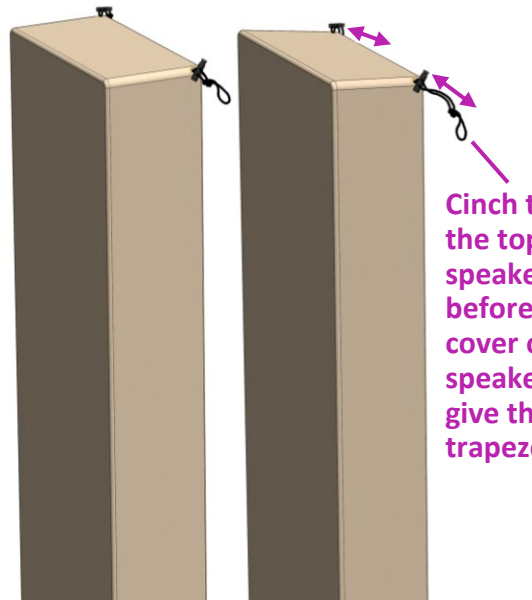

Cinch the cords at the top of the speaker cover before hanging the cover on the speaker. This will give the cover a trapezoidal shape.

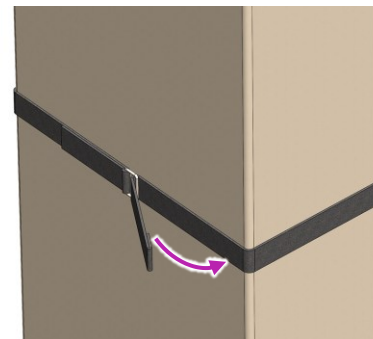

## Care and Maintenance

To remove dirt, use water and a soft cloth. Do not use a power washer to clean your outdoor speaker. This can damage the speaker and will void the warranty.

To remove stubborn dirt and fingerprints from the grille, we recommend isopropyl alcohol and a soft cloth. Lightly dampen the cloth with alcohol first and then clean the grille with the cloth. Do not use excessive amounts of alcohol –there is no need for the cloth to be wet.

Never attempt to clean the drivers themselves.

### Caution!

**Do not touch the surface of the planar magnetic drivers, under any circumstances.** The thin film has been carefully pre-tensioned at the factory; any subsequent contact can only damage it.

## **North American Warranty**

### **Standard Warranty**

When purchased from and installed by an authorized Wisdom Audio dealer, Wisdom Audio loudspeakers are warranted to be free from defects in material and workmanship under normal use for a period of 10 years from the original date of purchase.

Furthermore, the transducers (“drivers”) in your Wisdom Audio speakers are warranted to be free from defects in material and workmanship under normal use for a period of 10 years from the original date of purchase.

### **Harsh Conditions Use**

Wisdom Audio loudspeakers are designed for installation and operation in environmentally controlled conditions, such as are found in normal residential environments. When used in harsh conditions such as outdoors or in marine applications, the warranty is three years from the original date of purchase.

During the warranty period, any Wisdom Audio products exhibiting defects in materials and/or workmanship will be repaired or replaced at our option, without charge for either parts or labor, at our factory. The warranty will not apply to any Wisdom Audio products that have been misused, abused, altered, or installed and calibrated by anyone other than an authorized Wisdom Audio dealer.

Any Wisdom Audio product not performing satisfactorily may be returned to the factory for evaluation. Return authorization must first be obtained by either calling or writing the factory prior to shipping the component. The factory will pay for return shipping charges only if the component is found to be defective as mentioned above. There are other stipulations that may apply to shipping charges.

There is no other express warranty on Wisdom Audio products. Neither this warranty nor any other warranty, express or implied, including any implied warranties of merchantability or fitness, shall extend beyond the warranty period. No responsibility is assumed for any incidental or consequential damages. Some states do not allow limitations on how long an implied warranty lasts and other states do not allow the exclusion or limitation of incidental or consequential damages, so the above limitation or exclusion may not apply to you.

This warranty gives you specific legal rights, and you may also have other rights, which vary from state to state. This warranty is applicable in the United States and Canada only. Outside of the U.S. and Canada, please contact your local, authorized Wisdom Audio distributor for warranty and service information.

## Obtaining Service

We take great pride in our dealers. Experience, dedication, and integrity make these professionals ideally suited to assist with our customers' service needs.

If your Wisdom Audio loudspeaker must be serviced, please contact your dealer. Your dealer will then decide whether the problem can be remedied locally, or whether to contact Wisdom Audio for further service information or parts, or to obtain a Return Authorization. The Wisdom Audio Service Department works closely with your dealer to solve your service needs expediently.

**IMPORTANT:** Return authorization must be obtained from Wisdom Audio's Service Department BEFORE a unit is shipped for service.

It is extremely important that information about a problem be explicit and complete. A specific, comprehensive description of the problem helps your dealer and the Wisdom Audio Service Department locate and repair the difficulty as quickly as possible.

A copy of the original bill of sale will serve to verify warranty status. Please include it with the unit when it is brought in for warranty service.

**CAUTION:** All returned units must be packaged in their original packaging, and the proper return authorization numbers must be marked on the outer carton for identification. Shipping the unit in improper packaging may void the warranty, as Wisdom Audio cannot be responsible for the resulting shipping damage.

Your dealer can order a new set of shipping materials for you if you need to ship your loudspeaker and no longer have the original materials. There will be a charge for this service. We strongly recommend saving all packing materials in case you need to ship your unit someday.

If the packaging to protect the unit is, in our opinion or that of our dealer, inadequate to protect the unit, we reserve the right to repackage it for return shipment at the owner's expense. Neither Wisdom Audio nor your dealer can be responsible for shipping damage due to improper (that is, non-original) packaging.

# Dimensions

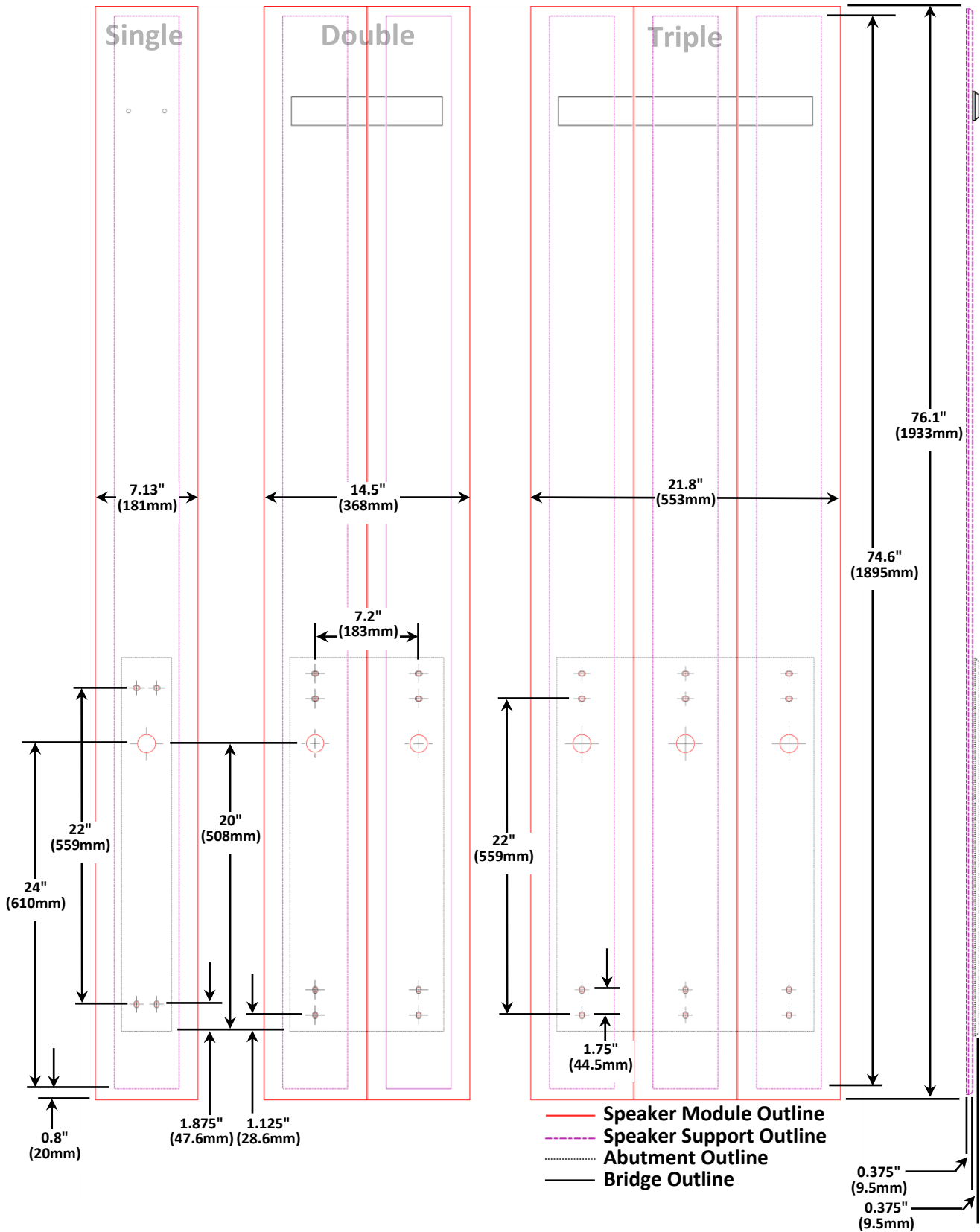



*WISDOM and the stylized W are registered trademarks of Wisdom Audio.*

Wisdom Audio 1572 College Parkway, Suite 164  
Carson City, Nevada 89706 USA  
TEL (775) 887-8850  
FAX (775) 887-8820  
wisdomaudio.com