

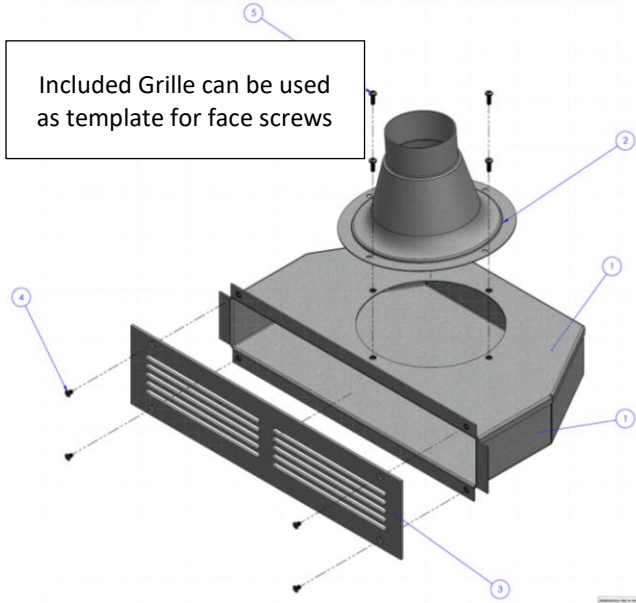

WISDOM

# Sub1 Toe Kick Accessory

## Assembly and Installation



Cutout Dimension:	2.56" H x 14.62" W 66mm H x 372mm W
Flange / Grille Dimension:	4.0" H x 16.0" W 102mm H x 407mm W
Rear Assembly Dimension:	7.23" H x 9.18" 14.62" W 184mm x 234mm x 372mm Not including SUB1 Port Tube
Minimum Depth Required:	14.62" 372mm Does not Include the Sub1
Minimum Height Required:	16.00" 407mm Includes height for the SUB1 Port Tube attachment
Typical Wall Thickness	5/8" 16mm
Grille Mounting Pattern	13.5" x 3.25" 343mm x 82.5mm

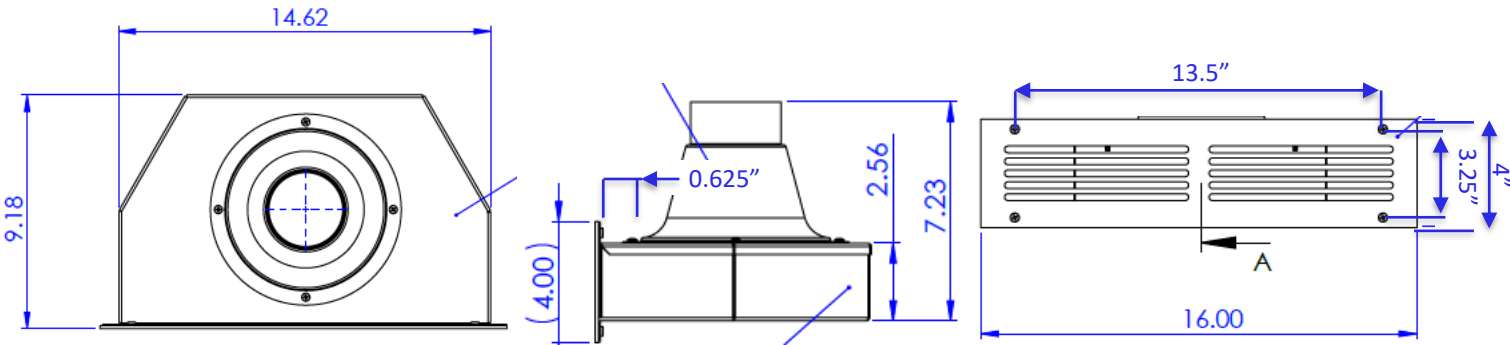

The below instructions are for working with an installed cabinet that has the proper access to the inside of the cabinet. If you are installing during the rough-in phase or will be using a custom grille, the below instructions may need to be modified. Consult with the carpenter or other subcontractors on the build. The toe kick is installed in the same way as a HVAC toe kick would be installed.

1. Cut the opening in the toe kick of the cabinet to fit the toe kick back box into the cabinet toe kick rough opening.
2. Slide the back box into the opening in the cabinet toe kick trim or rough-in
3. Using wood screws attach the back box flange to the face of the cabinet toe kick. Alternatively, the back box can be rear mounted or mounted to an unfinished / rough-in surface with the finished surface added later as long as the opening for the outlet is cut into the finish layer material without obstructing the exit.
4. Using the included screws (x6) attach the Port Tube Cone to the Toe Kick box. Ensure the gasket makes a good seal around the flange and tighten by hand.
5. Attach the Grille:
  - a. If using the included grille, align the mounting holes of the grille to the flange on the toe kick back box and screw through the grille and flange into the face of the cabinet toe kick. This will clamp the grille and back box to the cabinetry.
  - b. If using a custom grille, the back box screw mounting can be used, or the 4 corners of the back box allow for the grille to screw directly to the face of the toe kick trim. Alternatively, a custom grille can be screwed into the back box mounting locations or can be attached directly to the finish surface trim. Consult with the carpenter or HVAC installer.
6. Attach the Port Tube from the SUB1 (tube and clamps are included with the SUB1) and install the SUB1 as normal.